

4510

DIMS IN:

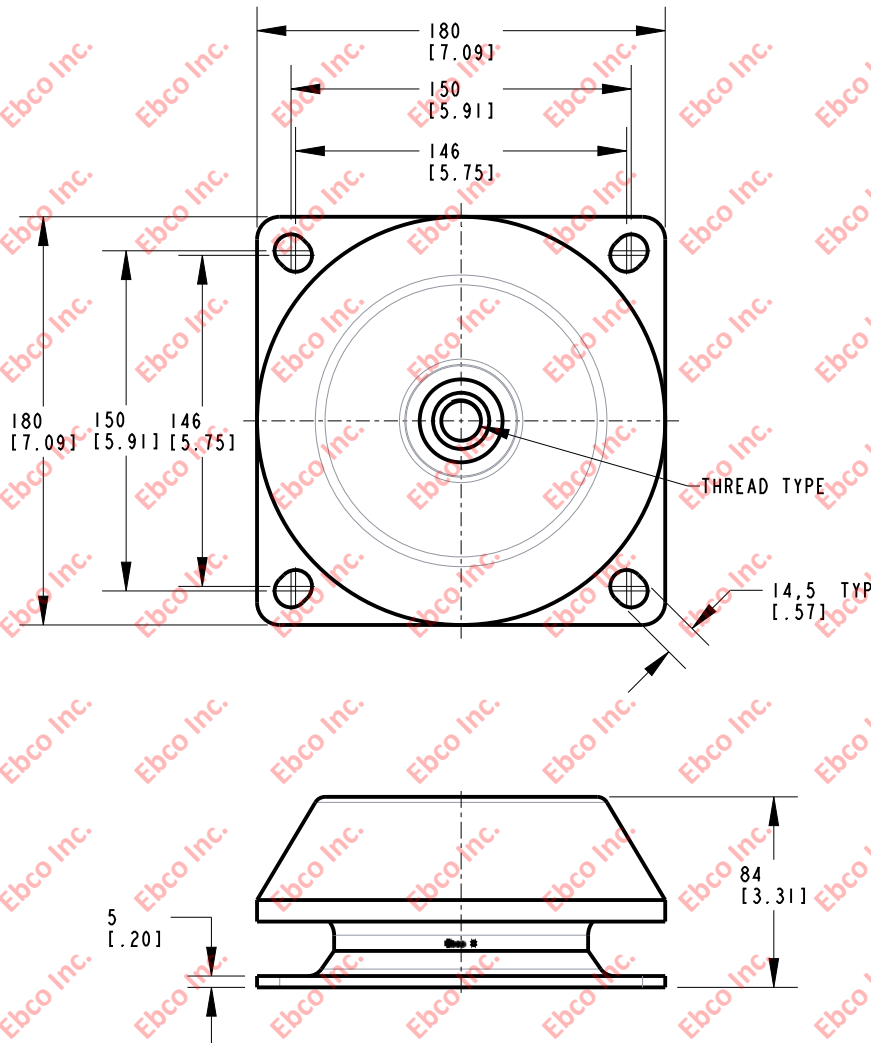

INSTALLATION VIEW (Shown under no load)

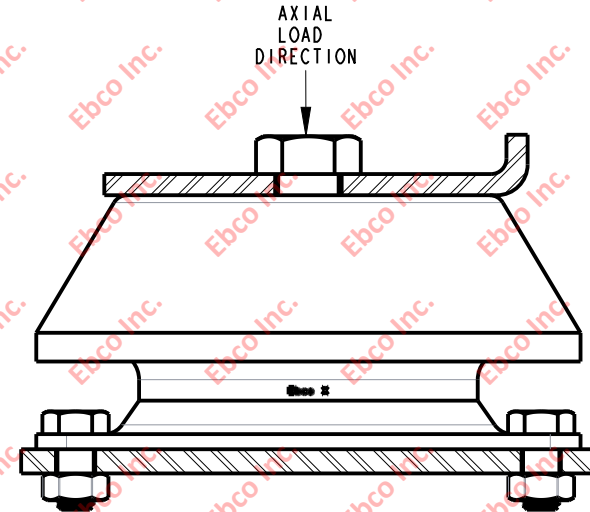

## SPECIFICATIONS

| PART NUMBER    |          | MAX. AXIAL DEFLECTION |      | MAX. AXIAL LOAD |       |
|----------------|----------|-----------------------|------|-----------------|-------|
| NATURAL RUBBER | NEOPRENE | in                    | mm   | lb              | N     |
| 4510-71        | 4510-81  | .50                   | 12.7 | 1905            | 8474  |
| 4510-73        | 4510-83  |                       |      | 2735            | 12166 |
| 4510-75        | 4510-85  |                       |      | 3835            | 17059 |
| 4510-77        | 4510-87  |                       |      | 5595            | 24888 |

## HARDWARE SPECIFICATIONS

| PART NUMBER | THREAD TYPE |
|-------------|-------------|
| 4510-XX     | M20X2.5-6H  |



|                                                                                                                                                                        |                  |
|------------------------------------------------------------------------------------------------------------------------------------------------------------------------|------------------|
| TITLE: 4510                                                                                                                                                            |                  |
| THE INFORMATION CONTAINED IN THIS DRAWING IS THE SOLE PROPERTY OF EBSCO. ANY REPRODUCTION IN PART OR AS A WHOLE WITHOUT THE WRITTEN PERMISSION OF EBSCO IS PROHIBITED. |                  |
| TOLERANCES PER RMA STANDARD A3                                                                                                                                         | REV. A           |
| DATE: 12-04-24                                                                                                                                                         | UNITS: mm [INCH] |
| 1330 HOLMES RD. ELGIN, IL 60123                                                                                                                                        |                  |

SPECIFICATIONS SUBJECT TO CHANGE