

2446

DRG. NO.

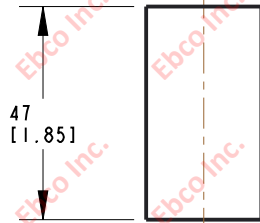

INSTALLATION VIEW (Shown under no load)

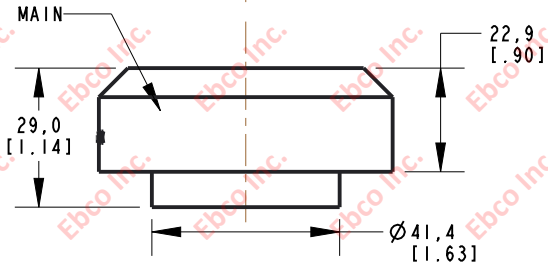
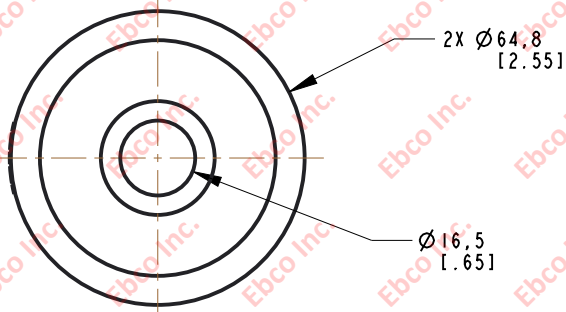
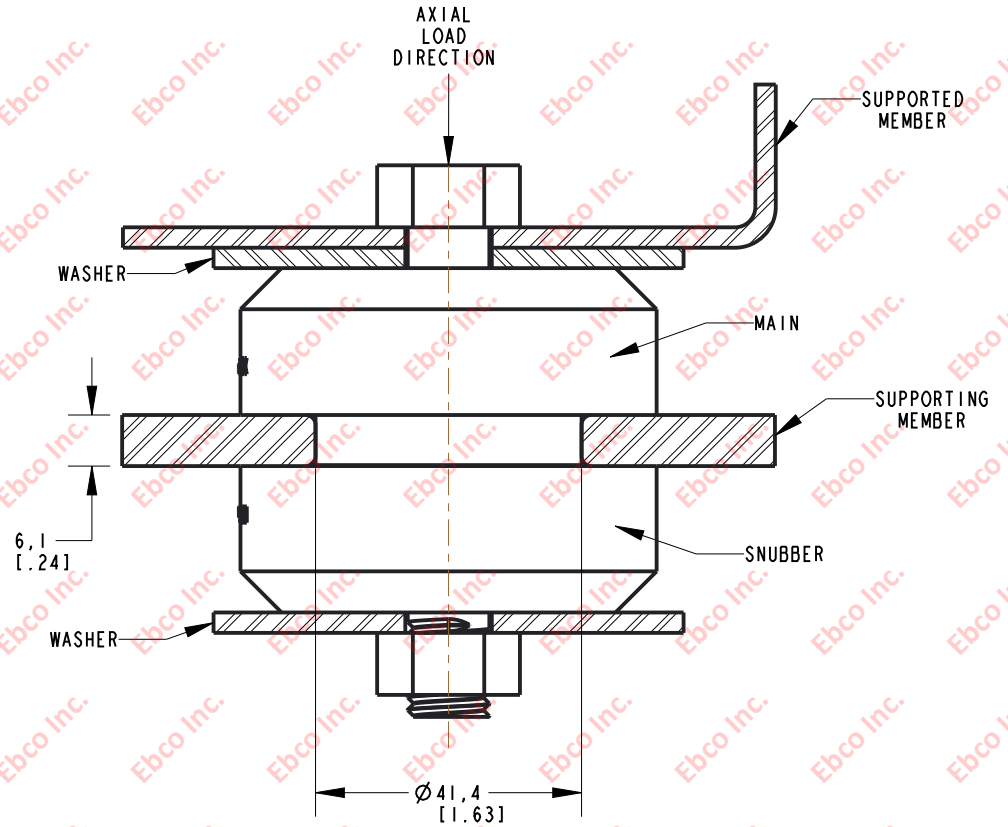

INSTALLATION DIMENSIONS

| RECOMMENDED BOLT INFORMATION | | | | TIGHTENING TORQUE | | | |
|------------------------------|-------|--------|-------|-------------------|-------|-------------------|-----|
| ENGLISH | | METRIC | | CLAMP LOAD | | TIGHTENING TORQUE | |
| SIZE | GRADE | SIZE | CLASS | lb | N | ft-lb | N-m |
| 5/8 | 5 | M16 | 9.8 | 14408 | 64090 | 150 | 203 |

| WASHER SPECIFICATIONS | | | | | |
|-----------------------|-------|-------|-------|-----------|------|
| O. D. | | I. D. | | THICKNESS | |
| in | mm | in | mm | in | mm |
| 2.88 | 73.15 | .64 | 16.26 | .125 | 3.18 |

SPECIFICATIONS

| PART NUMBER | | MAX. AXIAL DEFLECTION | | MAX. AXIAL LOAD | |
|----------------|----------|-----------------------|------|-----------------|------|
| NATURAL RUBBER | NEOPRENE | in | mm | lb | N |
| 2446-73 | 2446-83 | .09 | 2.29 | 350 | 1557 |
| 2446-75 | 2446-85 | | | 575 | 2558 |
| 2446-77 | 2446-87 | | | 950 | 4226 |



| | |
|---|------------------|
| TITLE: | 2446 |
| THE INFORMATION CONTAINED IN THIS DRAWING IS THE SOLE PROPERTY OF EBCO ANY REPRODUCTION IN PART OR AS A WHOLE WITHOUT THE WRITTEN PERMISSION OF EBCO IS PROHIBITED. | |
| TOLERANCES PER RMA STANDARD A3 | REV. D |
| DATE: 06-09-21 | UNITS: mm [INCH] |
| 1330 HOLMES RD. ELGIN, IL 60123 | |

SPECIFICATIONS SUBJECT TO CHANGE