

2340

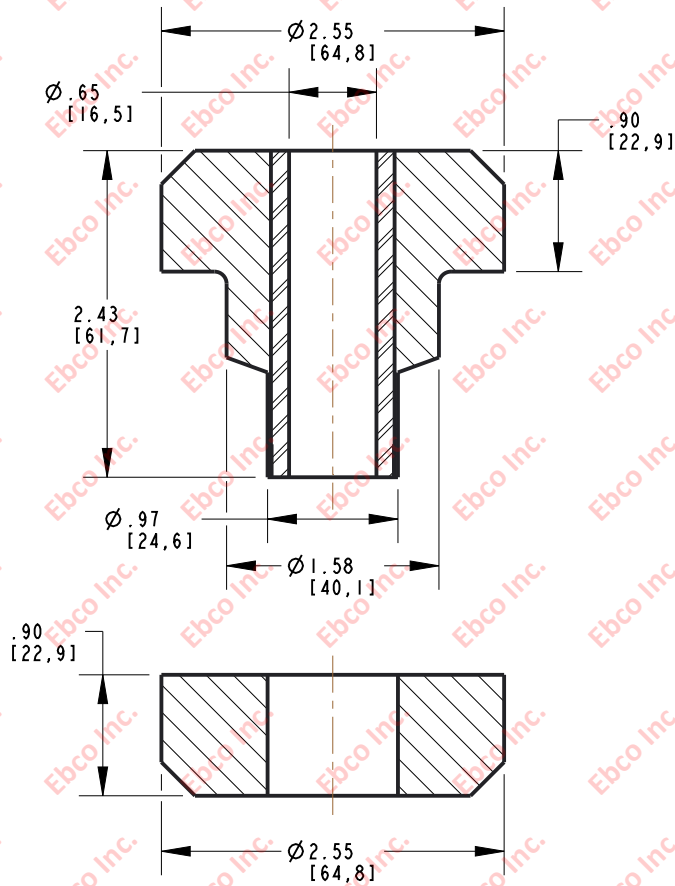

INSTALLATION VIEW (Shown under no load)

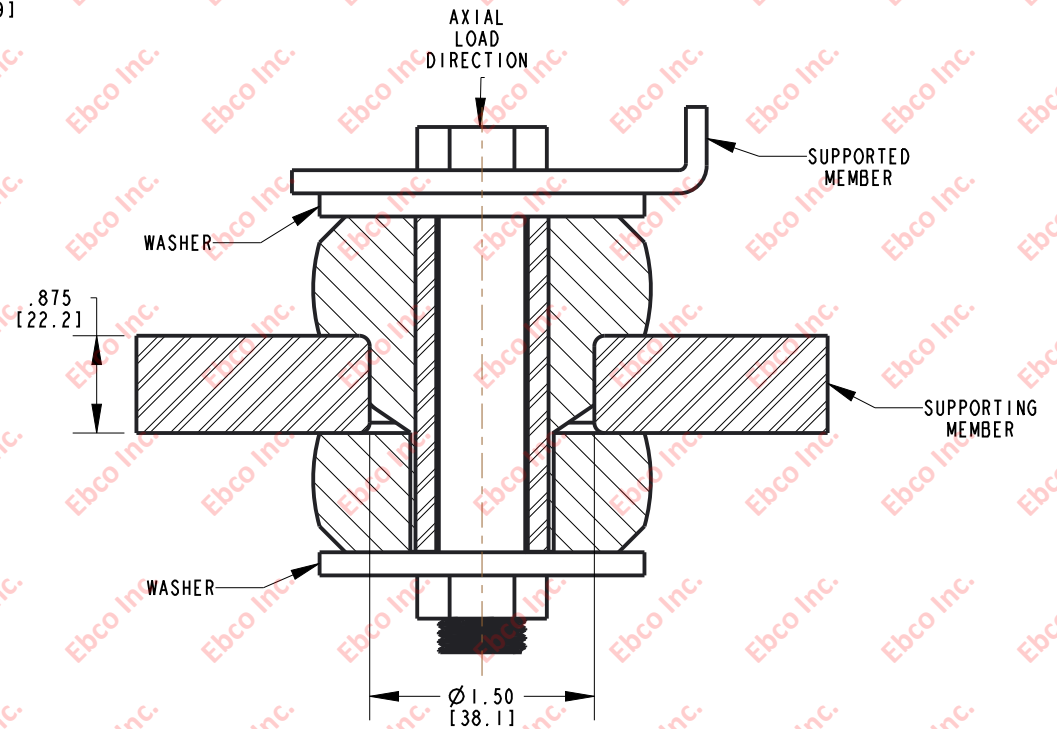

SPECIFICATIONS

| PART NUMBER    |          | MAX. AXIAL DEFLECTION |      | MAX. AXIAL LOAD |      |
|----------------|----------|-----------------------|------|-----------------|------|
| NATURAL RUBBER | NEOPRENE | in                    | mm   | lb              | N    |
| 2340-71        | 2340-81  | .09                   | 2.29 | 250             | 1112 |
| 2340-72        | 2340-82  |                       |      | 300             | 1335 |
| 2340-73        | 2340-83  |                       |      | 400             | 1780 |
| 2340-74        | 2340-84  |                       |      | 500             | 2225 |
| 2340-75        | 2340-85  |                       |      | 600             | 2669 |
| 2340-76        | 2340-86  |                       |      | 750             | 3338 |
| 2340-77        | 2340-87  |                       |      | 900             | 4005 |
| 2340-78        | 2340-88  |                       |      | 1300            | 5783 |
| 2340-79        | 2340-89  |                       |      | 1600            | 7117 |

INSTALLATION DIMENSIONS

| RECOMMENDED BOLT INFORMATION |       |        |       | TIGHTENING TORQUE |       |                   |     |
|------------------------------|-------|--------|-------|-------------------|-------|-------------------|-----|
| ENGLISH                      |       | METRIC |       | CLAMP LOAD        |       | TIGHTENING TORQUE |     |
| SIZE                         | GRADE | SIZE   | CLASS | lb                | N     | ft-lb             | N-m |
| 5/8                          | 5     | M16    | 9.8   | 14408             | 64090 | 150               | 203 |
| WASHER SPECIFICATIONS        |       |        |       |                   |       |                   |     |
| O. D.                        |       | I. D.  |       | THICKNESS         |       |                   |     |
| in                           | mm    | in     | mm    | in                | mm    |                   |     |
| 2.81                         | 71.37 | .657   | 16.69 | .188              | 4.78  |                   |     |



|   |                  |
|---|------------------|
| TITLE: 2340   |                  |
| THE INFORMATION CONTAINED IN THIS DRAWING IS THE SOLE PROPERTY OF EBCO ANY REPRODUCTION IN PART OR AS A WHOLE WITHOUT THE WRITTEN PERMISSION OF EBCO IS PROHIBITED. |                  |
| TOLERANCES PER RMA STANDARD A3  | REV. E           |
| DATE: 09-09-20  | UNITS: INCH [MM] |
| 1330 HOLMES RD. ELGIN, IL 60123   |                  |

SPECIFICATIONS SUBJECT TO CHANGE