

2334A

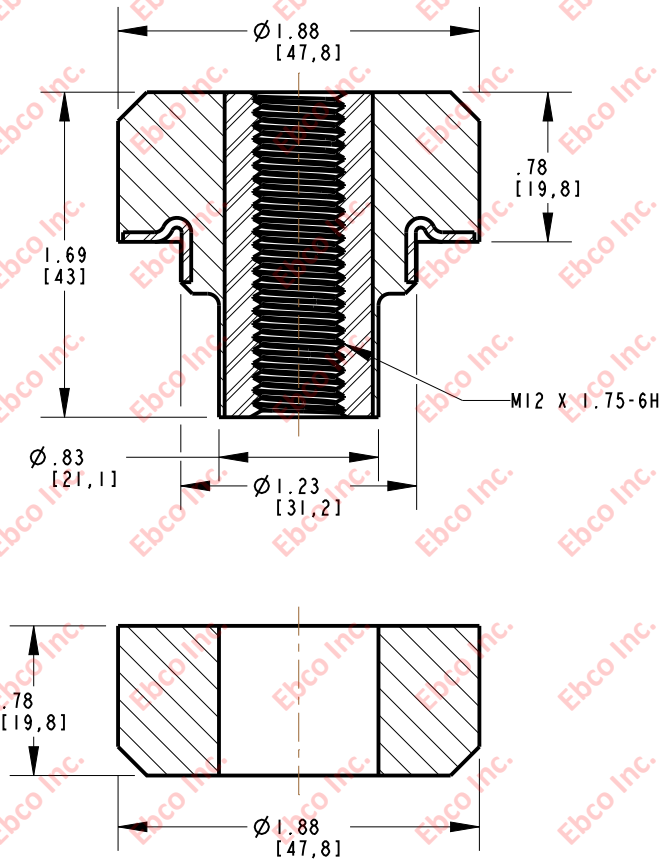

INSTALLATION VIEW (Shown under no load)

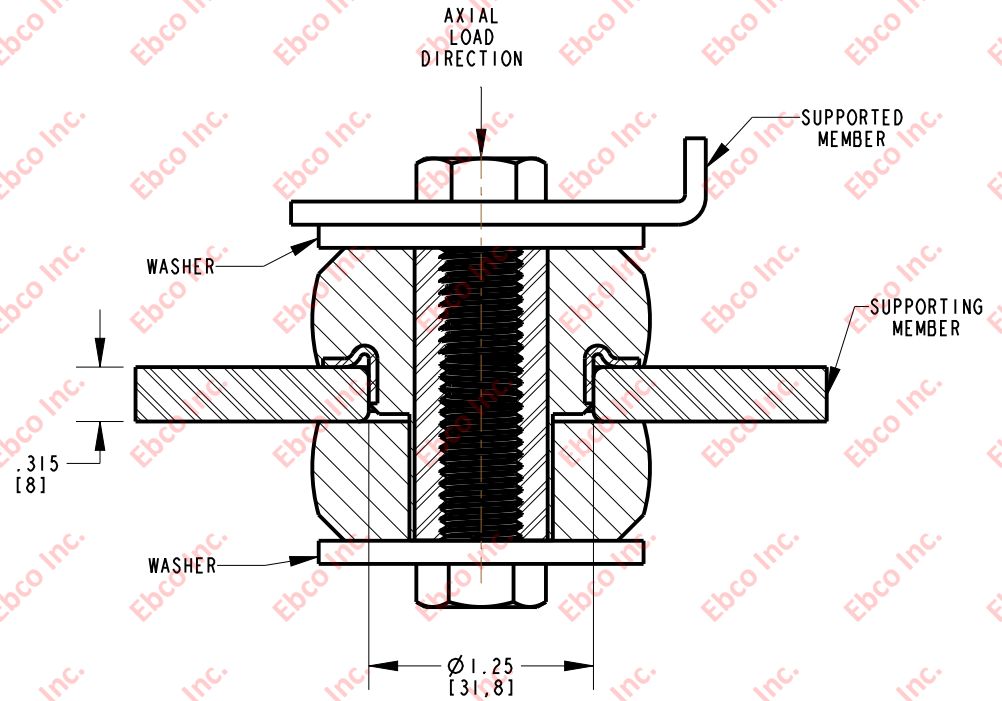

INSTALLATION DIMENSIONS

| BOLT | | TIGHTENING TORQUE | | | |
|--------|-------|-------------------|-------|-------------------|------|
| METRIC | | CLAMP LOAD | | TIGHTENING TORQUE | |
| SIZE | CLASS | lb | N | ft-lb | N-m |
| M12 | 9.8 | 9240 | 41100 | 72.7 | 98.6 |

| WASHER SPECIFICATIONS | | | | | |
|-----------------------|-------|-------|-------|-----------|------|
| O. D. | | I. D. | | THICKNESS | |
| in | mm | in | mm | in | mm |
| 2.13 | 54.10 | .53 | 13.46 | .134 | 3.40 |

SPECIFICATIONS

| PART NUMBER | | MAX. AXIAL DEFLECTION | | MAX. AXIAL LOAD | |
|----------------|----------|-----------------------|------|-----------------|------|
| NATURAL RUBBER | NEOPRENE | in | mm | lb | N |
| 2334A-78 | 2334A-88 | .07 | 1.78 | 650 | 2891 |



TITLE: 2334A

THE INFORMATION CONTAINED IN THIS DRAWING IS THE SOLE PROPERTY OF EBCO. ANY REPRODUCTION IN PART OR AS A WHOLE WITHOUT THE WRITTEN PERMISSION OF EBCO IS PROHIBITED.

TOLERANCES PER RMA STANDARD A3

REV. C

DATE: 08-12-13

UNITS: INCH [MM]

1330 HOLMES RD. ELGIN, IL 60123

SPECIFICATIONS SUBJECT TO CHANGE