

2320

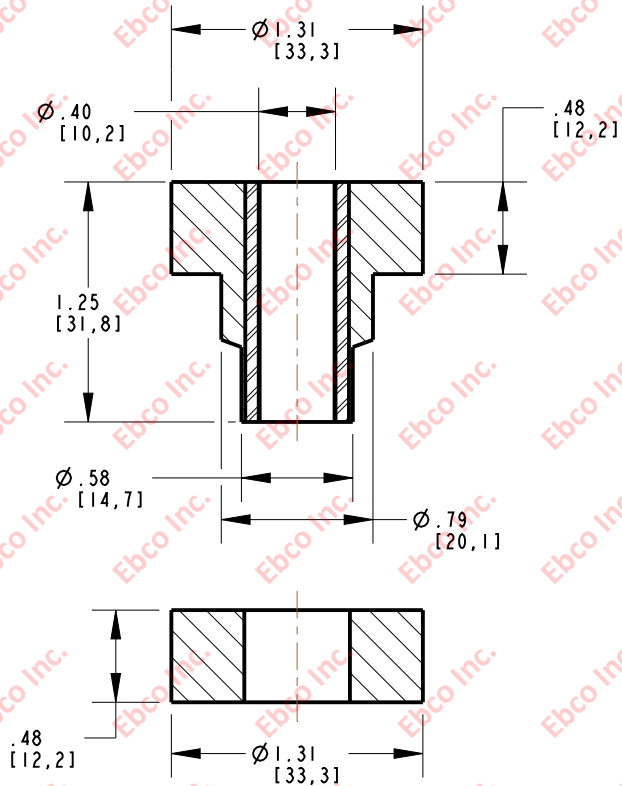

INSTALLATION VIEW (Shown under no load)

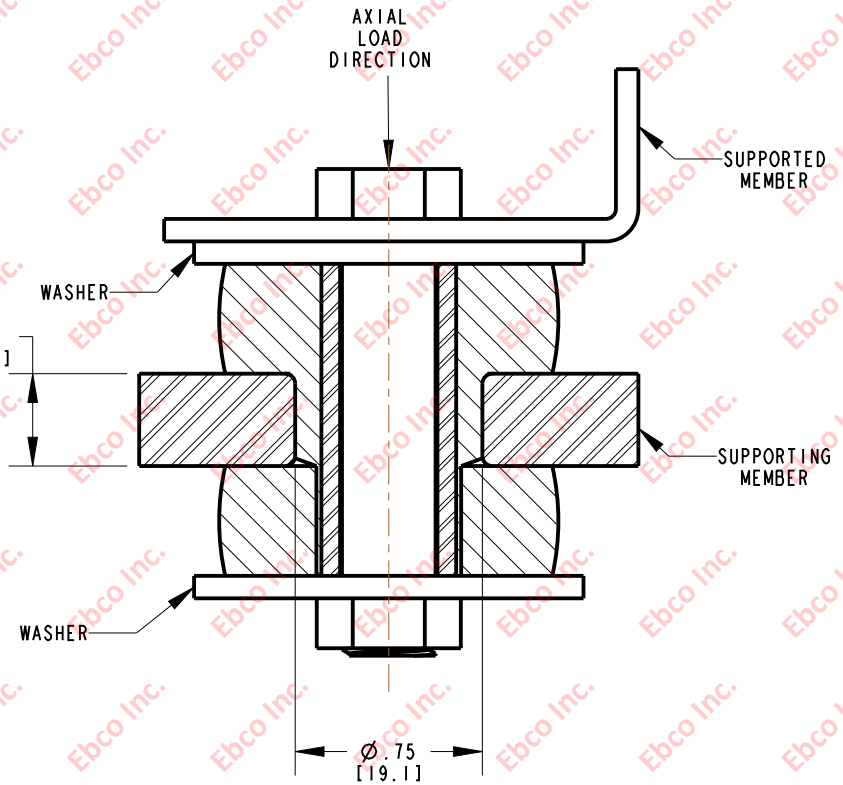

SPECIFICATIONS

| PART NUMBER | | MAX. AXIAL DEFLECTION | | MAX. AXIAL LOAD | |
|----------------|----------|-----------------------|------|-----------------|------|
| NATURAL RUBBER | NEOPRENE | in | mm | lb | N |
| 2320-700 | 2320-800 | 0.05 | 1.27 | 45 | 200 |
| 2320-70 | 2320-80 | | | 60 | 267 |
| 2320-71 | 2320-81 | | | 75 | 334 |
| 2320-72 | 2320-82 | | | 90 | 401 |
| 2320-73 | 2320-83 | | | 120 | 534 |
| 2320-74 | 2320-84 | | | 150 | 668 |
| 2320-75 | 2320-85 | | | 190 | 845 |
| 2320-76 | 2320-86 | | | 250 | 1113 |
| 2320-77 | 2320-87 | | | 310 | 1380 |
| 2320-78 | 2320-88 | | | 400 | 1779 |

INSTALLATION DIMENSIONS

| RECOMMENDED BOLT INFORMATION | | | | TIGHTENING TORQUE | | | |
|------------------------------|-------|--------|-------|-------------------|-------|-------------------|-------|
| ENGLISH | | METRIC | | CLAMP LOAD | | TIGHTENING TORQUE | |
| SIZE | GRADE | SIZE | CLASS | lb | N | ft-lb | N-m |
| 3/8 | 5 | M10 | 9.8 | 4941 | 21979 | 30.9 | 41.72 |
| WASHER SPECIFICATIONS | | | | | | | |
| O. D. | | I. D. | | THICKNESS | | | |
| in | mm | in | mm | in | mm | | |
| 1.56 | 39.62 | .391 | 9.93 | .09 | 2.29 | | |



| | |
|--|------------------|
| TITLE: 2320 | |
| THE INFORMATION CONTAINED IN THIS DRAWING IS THE SOLE PROPERTY OF EBCO. ANY REPRODUCTION IN PART OR AS A WHOLE WITHOUT THE WRITTEN PERMISSION OF EBCO IS PROHIBITED. | |
| TOLERANCES PER RMA STANDARD A3 | REV. B |
| DATE: 08-12-13 | UNITS: INCH [MM] |
| 1330 HOLMES RD. ELGIN, IL 60123 | |

SPECIFICATIONS SUBJECT TO CHANGE