

2245

IMP. NO.

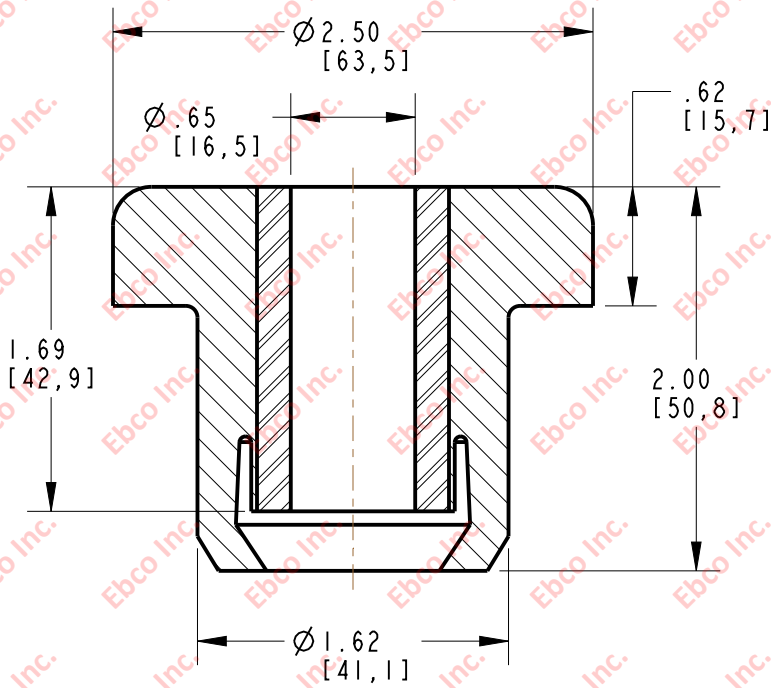

INSTALLATION VIEW (Shown under no load)

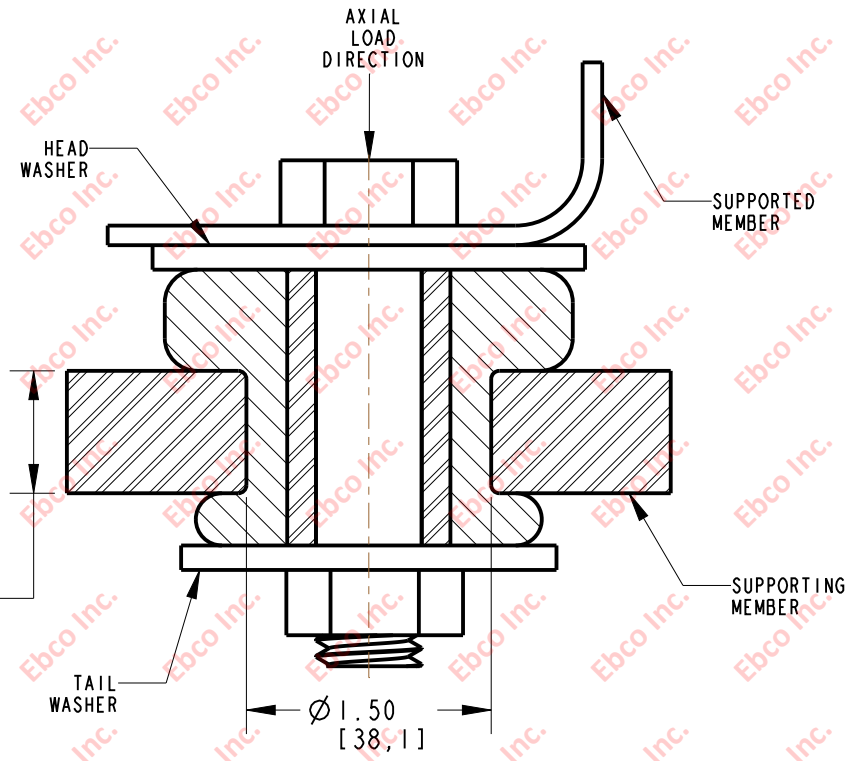

INSTALLATION DIMENSIONS

| RECOMMENDED BOLT INFORMATION |       |        |       | TIGHTENING TORQUE |       |                   |     |
|------------------------------|-------|--------|-------|-------------------|-------|-------------------|-----|
| ENGLISH                      |       | METRIC |       | CLAMP LOAD        |       | TIGHTENING TORQUE |     |
| SIZE                         | GRADE | SIZE   | CLASS | lb                | N     | ft-lb             | N-m |
| 5/8                          | 5     | M16    | 9.8   | 14408             | 64090 | 150               | 203 |

| WASHER SPECIFICATIONS |      |       |      |       |           |      |
|-----------------------|------|-------|------|-------|-----------|------|
| TYPE                  | O.D. |       | I.D. |       | THICKNESS |      |
|                       | in   | mm    | in   | mm    | in        | mm   |
| HEAD                  | 2.75 | 69.85 | .64  | 16.26 | .125      | 3.18 |
| TAIL                  | 2.50 | 63.50 | .64  | 16.26 |           |      |

SPECIFICATIONS

| PART NUMBER    |          | MAX. AXIAL DEFLECTION |      | MAX. AXIAL LOAD |      |
|----------------|----------|-----------------------|------|-----------------|------|
| NATURAL RUBBER | NEOPRENE | in                    | mm   | lb              | N    |
| 2245-76        | 2245-86  | .06                   | 1.52 | 650             | 2891 |
| 2245-77        | 2245-87  |                       |      | 800             | 3558 |
| 2245-78        | 2245-88  |                       |      | 1000            | 4448 |



|  |                  |
|--|------------------|
| TITLE: 2245  |                  |
| THE INFORMATION CONTAINED IN THIS DRAWING IS THE SOLE PROPERTY OF EBCO. ANY REPRODUCTION IN PART OR AS A WHOLE WITHOUT THE WRITTEN PERMISSION OF EBCO IS PROHIBITED. |                  |
| TOLERANCES PER RMA STANDARD A3   | REV. A           |
| DATE: 06-03-14   | UNITS: INCH [MM] |
| 1330 HOLMES RD. ELGIN, IL 60123  |                  |

SPECIFICATIONS SUBJECT TO CHANGE